



**For General Information:**

Contact Lewis EDC at  
 (360) 748-0114

**208 Maurin Road**

**Building Size:** 172,875 sf  
**Zoning:** Industrial  
**Power:** Lewis County PUD  
**Water:** City  
**Sewer:** City  
**Natural Gas:** Puget Sound Energy  
**Use:** Distribution



**Listing comments**

- 27' Clear height
- 22 Dock-high, 1 grade-level loading door
- Column spacing: 48'x50'
- ESFR sprinklers
- Excess land for potential trailer storage
- Perimeter fencing with guard shack to maximize security
- 13.88 acres

**For Specific Information:**

Contact Kidder Mathews  
 Vanessa Herzog or Matt Ward  
 253-722-1400

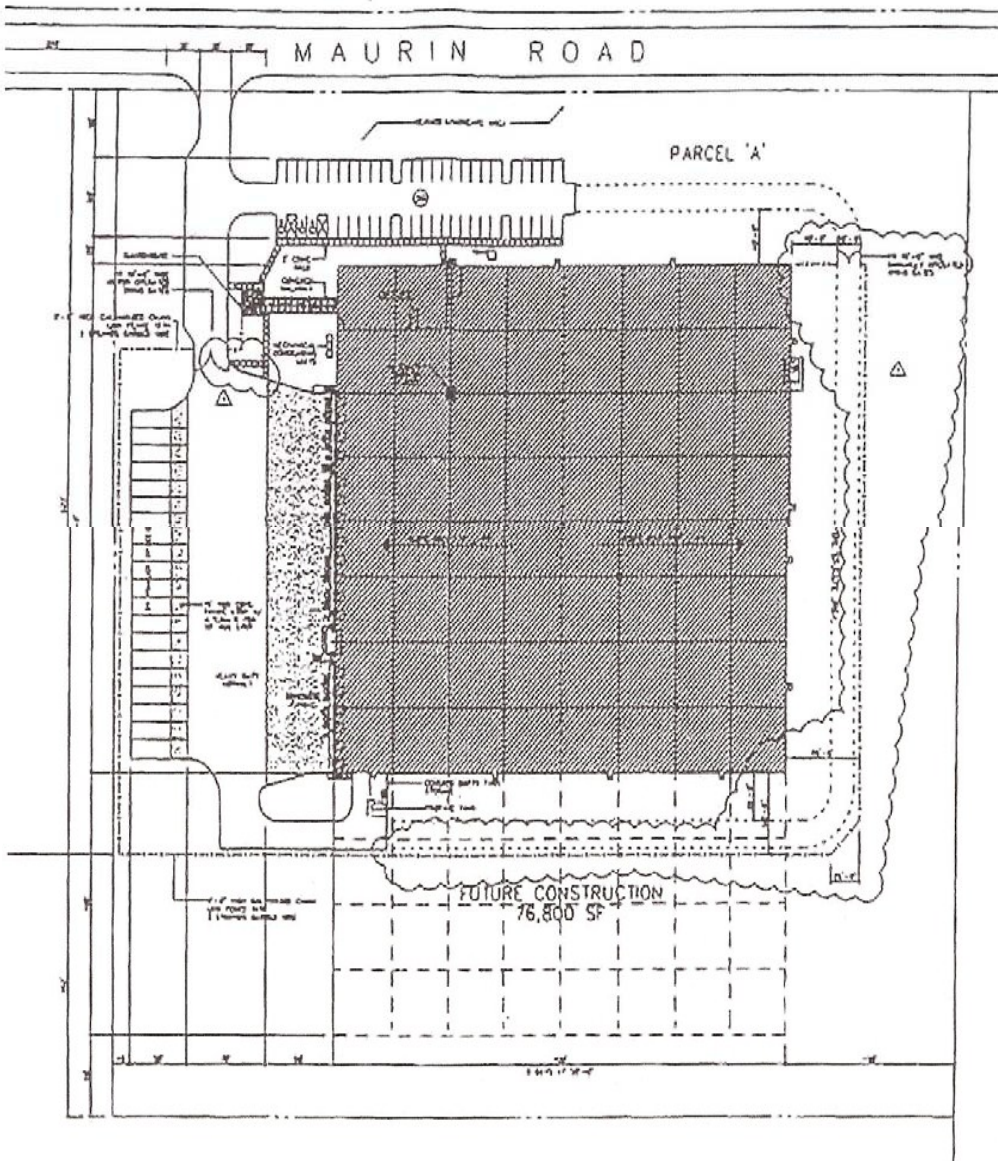

**For General Information:**  
  
Contact Lewis EDC  
At 360-748-0114

**208 Maurin Road**

**For Specific Information :**  
Contact Kidder Mathews  
Vanessa Herzog or Matt Ward  
253-722-1400